



3 Bed Villa (Detached) For Sale

€1,500,000

Estepona, Costa del Sol

Ref: R4643602

Villa located in the heart of the Costa del Sol, just 8 minutes from the beach and 15 minutes from Marbella and Sotogrande, a dream place with enormous landscape wealth where numerous beaches are distributed between the mountains and the sea of El Castillo de la Duquesa, Manilva, Estepona, to Puerto Banús and Benahavis. Very close to the exclusive Valle Romano Golf & Resort and the Sotogrande Polo clubs. The special features of the project have made the most of the unbeatable conditions of the plot through an inverted house with a spectacularly designed pool. The special features of the project have made the most of the unbeatable conditions of the plot through an inverted house with a spectacularly designed pool. The house is made up of 3 floors: It is accessed by pedestrian and v...

Telephone: +34 637 87 73 78

Email: info@banusimmo.com

La Reserva Del Alczucuz, La Azalia 1 -1B, 29679, Benahavis

BanusImmo
MARBELLA

Gallery

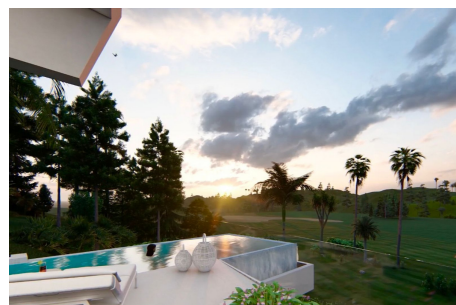

Telephone: +34 637 87 73 78

Email: info@banusimmo.com

La Reserva Del Alczucuz, La Azalia 1 -1B, 29679, Benahavis

Banus Immo
MARBELLA

Property Description

Location: Estepona, Costa del Sol, Spain

Villa located in the heart of the Costa del Sol, just 8 minutes from the beach and 15 minutes from Marbella and Sotogrande, a dream place with enormous landscape wealth where numerous beaches are distributed between the mountains and the sea of El Castillo de la Duquesa, Manilva, Estepona, to Puerto Banús and Benahavis.

Very close to the exclusive Valle Romano Golf & Resort and the Sotogrande Polo clubs. The special features of the project have made the most of the unbeatable conditions of the plot through an inverted house with a spectacularly designed pool.

The special features of the project have made the most of the unbeatable conditions of the plot through an inverted house with a spectacularly designed pool.

The house is made up of 3 floors:

It is accessed by pedestrian and vehicle from a higher level of the plot, to an entrance patio where we find a fabulous wooden walkway that gives access to the interior of the house.

Once inside, from the master bedroom you can see the magnitude of the back of the house and its evocative views of the mountains. With an unbeatable entrance of natural light and with the highest terrace in the house we will be in full contact with the nature that surrounds this enclave.

The house is functionally connected vertically with an exclusively designed elevator and a staircase that recreates a totally unique vertical space.

If we continue the journey one floor lower we will reach the double-height central area that is the heart of the home from where everything is understood and everything is visualized.

Once here we finish understanding the magnitude of the design chosen for this villa, we find ourselves in front of a spectacular infinity pool, a pool that flies, with the sensation of seeing it floating in the air.

Taking into account other more technical descriptive issues of the house, it has a total constructed area of 435 m² with porches and terraces. With the following distribution of uses by plants:

Upper Access Floor: Entrance hall, the best place to appreciate the interior dimension of the home. The master bedroom and its terrace create the balcony with the best views of the outside of the house. Additionally, this floor has a full bathroom and a dressing room.

Lower Noble Floor: The living room, dining room and kitchen create a completely open space that extends along its entire front towards a terrace of almost 30m² and the garden, where a swimming

pool with a very unique design begins, flying above the ground.

From the bedroom on this floor we can connect with the outside porch, a pergola space where we can enjoy the terrace and bathroom area.

Basement floor: Gym & SPA, games room and wine cellar, as well as laundry and service areas.

Detached Villa, Estepona, Costa del Sol.

3 Bedrooms, 2 Bathrooms, Built 420 m², Terrace 15 m², Garden/Plot 560 m².

Setting : Close To Port, Close To Shops, Close To Sea, Close To Town, Close To Schools, Close To Forest, Close To Marina, Urbanisation.

Orientation : South West, West.

Condition : New Construction.

Pool : Private.

Climate Control : Air Conditioning.

Views : Sea, Mountain, Golf, Beach, Panoramic, Urban, Street.

Features : Covered Terrace, Fitted Wardrobes, Near Transport, Private Terrace, Satellite TV, WiFi, Gym, Sauna, Storage Room, Utility Room, Marble Flooring, Barbeque, Double Glazing, Domotics, 24 Hour Reception, Basement, Fiber Optic.

Furniture : Fully Furnished.

Kitchen : Fully Fitted.

Garden : Private, Easy Maintenance.

Security : Electric Blinds, Alarm System, Safe.

Parking : Garage, Covered, Private.

Utilities : Electricity, Drinkable Water, Telephone, Gas, Solar water heating.

Category : Investment.

Additional Info

For Sale	Beds: 3	Baths: 2
Type: Villa (Detached)	Area: 435 sq m	Land Area: 560 sq m
Garden	Pool	Setting: Beachside
Close To Port	Close To Town	Close To Schools
Orientation: South West	Condition: New Construction	Pool: Private
Climate Control: Air Conditioning	Views: Sea	Mountain
Golf	Panoramic	Urban
Street	Covered Terrace	Fitted Wardrobes
Near Transport	Private Terrace	Satellite TV
Gym	Sauna	Storage Room
Utility Room	Marble Flooring	Barbeque
Double Glazing	Furniture: Fully Furnished	Kitchen: Fully Fitted
Garden: Private	Security: Alarm System	Parking: Private
Utilities: Telephone	Built Area : 435 sq m	Land Size : 560 sq m

Telephone: +34 637 87 73 78

Email: info@banusimmo.com

La Reserva Del Alcuuzcuz, La Azalia 1 -1B, 29679, Benahavis

Banus Immo
MARBELLA