

Plot For Sale

Benahavís, Costa del Sol

€410,000

Ref: R4082200

We have several plots for sale in Marbella Club Golf Resort, a private, gated complex, with 24-hour security and concierge service, private golf course and equestrian center. All the plots have beautiful views combining the forest of the area, with the golf course, the views of the sea and the African coast and some even the horse jumping competition track. The complex also has a very nice Club House with really professional service and friendly atmosphere. Specifically, this plot is facing and bending towards the southwest, meaning lots of daylight. It has sea views and also forest views. The urban regulations allow building about 604 m2 split between the ground floor and first floor, but you can also build an extra basement which, given the slope of the terrain, would also have beautifu...

Telephone: +34 637 87 73 78

Email: info@banusimmo.com

La Reserva Del Alcuercuz, La Azalia 1 -1B, 29679, Benahavis

BanusImmo
MARBELLA

Gallery

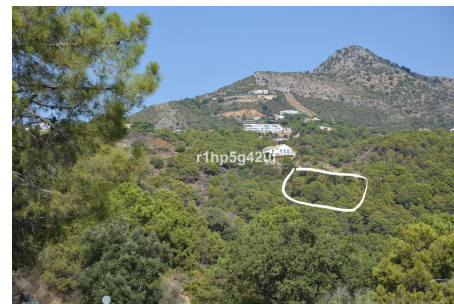
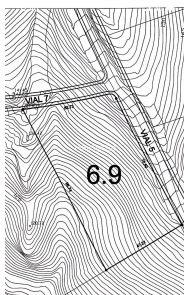

Telephone: +34 637 87 73 78

Email: info@banusimmo.com

La Reserva Del Alcuzcuz, La Azalia 1 -1B, 29679, Benahavis

Banus Immo
MARBELLA

Property Description

Location: Benahavís, Costa del Sol, Spain

We have several plots for sale in Marbella Club Golf Resort, a private, gated complex, with 24-hour security and concierge service, private golf course and equestrian center. All the plots have beautiful views combining the forest of the area, with the golf course, the views of the sea and the African coast and some even the horse jumping competition track. The complex also has a very nice Club House with really professional service and friendly atmosphere.

Specifically, this plot is facing and bending towards the southwest, meaning lots of daylight. It has sea views and also forest views. The urban regulations allow building about 604 m2 split between the ground floor and first floor, but you can also build an extra basement which, given the slope of the terrain, would also have beautiful views.

Additional Info

For Sale	Type: Plot	Land Area: 5723 sq m
Setting: Suburban	Country	Close To Golf
Close To Sea	Close To Town	Close To Schools
Close To Forest	Urbanisation	Orientation: South West
West	Pool: Room For Pool	Views: Sea
Mountain	Country	Panoramic
Forest	Bar	24 Hour Reception
Stables	Security: Gated Complex	24 Hour Security
Utilities: Electricity	Drinkable Water	Telephone
Category: Golf	Investment	Luxury
Land Size : 5723 sq m		

Telephone: +34 637 87 73 78

Email: info@banusimmo.com

La Reserva Del Alcuzcuz, La Azalia 1 -1B, 29679, Benahavis